

MAX PROP

AUTOMATIC FEATHERING PROPELLERS



MAXIMIZING YOUR PERFORMANCE AT SEA

www.propshopltd.com

AUTOMATIC FEATHERING PROPELLER

Max-Prop is the leading low drag propeller on the market today. Since starting production in the 1970's Max-Prop has proven itself on racing and cruising boats around the world. With over 35,000 propellers in the water, the Max-Prop is tested daily in the harshest conditions and has established itself as the most efficient and reliable low drag propeller.

The combination of low drag, outstanding reverse power, efficient forward performance and fail safe design makes Max-Prop the ideal Sailboat propeller on the market today. Now with the introduction of the ECOWIND, Max-Prop has taken a revolutionary step forward in the propulsion of Sailboats.

“The boat we sailed was equipped with a feathering Max-Prop, which is probably the single best investment that any cruising sailor could make to improve performance under both sail and power. Max-Props aren't cheap, but they're worth every penny if you're concerned about performance...”

- Practical Sailor Magazine

3 Blade Classic



RELIABILITY: Max-Prop uses a “differential” type design so all blades open in unison in forward or reverse. The extraordinary reliability of the Max-Prop has made it an overwhelming choice for long range cruisers.

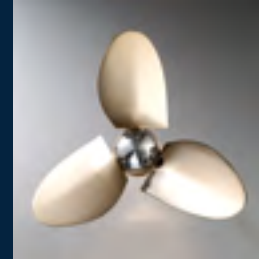

GREAT REVERSE: The Max-Prop provides 80% greater reverse power than a comparable fixed blade propeller. In reverse the blades rotate 180° in $\frac{3}{4}$ turn of the shaft giving the Max-Prop the same efficiency in reverse as in forward.

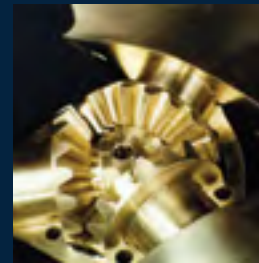

ADJUSTABILITY: The pitch is adjustable on all Max-Props. This allows you to optimize the propeller pitch to the engine to achieve maximum efficiency.

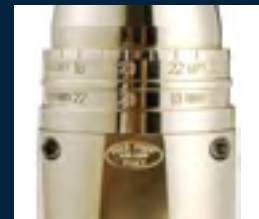

LOW DRAG: Under sail the Max-Prop will increase sailing speed by about 15%, the largest difference being noticed when sailing in light air. When sailing with a fixed propeller the vessel has to overcome the fixed blade drag, installing a Max-Prop maximizes sailing performance.

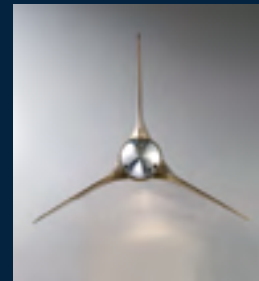

PROPELLER MODELS

2 & 3 Blade Classic

- Streamlined original design
- 40 years of proven performance and reliability
- Lowest sailing drag of any feathering propeller
- Outstanding reverse power
- Internally adjustable pitch
- 2 Blade is ideal for racing boats and smaller cruising boats
- 3 Blade smooth's out engine & drivetrain vibrations
- 3 Blade is ideal for a local and long range cruiser



3 & 4 Blade Easy

- Newer blade and hub design
- Very low sailing drag
- Great forward power in all conditions
- Same outstanding reverse as the Classic.
- Externally adjustable pitch (no need for a haul out)
- One piece installation (can be done easily by a diver, no need for a haul out)
- Ideal for local and long range cruiser

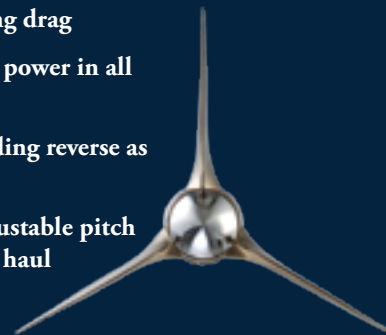

4 Blade V.P. Fast

- Completely redesigned hub and blades
- Very rugged construction
- Super smooth body (no fasteners are visible)
- Exceptional forward and reverse power
- Externally adjustable pitch (no need for a haul out)
- 4 blade design provides the smoothest possible run under power
- One piece installation
- Ideal for heavy displacement cruiser wanting the extra power and smoothness of a 4 blade

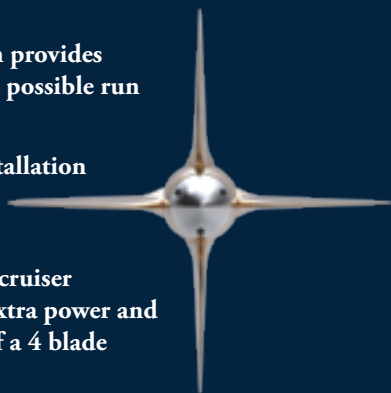

5 Blade Whisper

- Efficient power
- Outstanding reverse
- Ultra smooth operation
- Low drag
- Externally adjustable pitch (no need for a haul out)
- One piece installation (can be done easily by a diver, no need for a haul out)
- Ideal for heavy displacement cruiser wanting the extra power and smoothness of a 5 blade

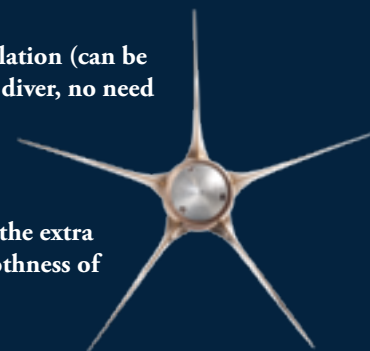

TWO & THREE BLADE CLASSIC

The original Max-Prop was designed in the early 70's for the high tech race boat market. Since proving itself in the racing arena, the Classic Max-Prop has earned its way into the mainstream market as the leader in low drag propellers. Today you will find the Classic Max-Prop on a wide range of vessels from modest 25 foot daysailer to 161' Blueose II.

With the increased popularity of the cruising vessel, Max-Prop introduced the three blade classic model in the early 80's. This propeller will enhance a vessel's performance both under power with less vibration, better power in load conditions and under sail with reduced drag.

With regards to performance under power, both two and three blade propellers will power the boat well in flat water. The three blade has a major advantage when going against heavy winds and seas, it will maintain the boat speed up to 30% better than the two blade. Moreover, a three blade propeller will run much smoother and reduce vibrations as it is balanced around three points as opposed to two.

With its unsurpassed performance in both forward and reverse, the Classic Max-Prop has become a legend among the sailing community.



Features

- **Efficient Power**
- **Outstanding Reverse**
- **Reduce Vibrations**
- **Unequaled Reliability**
- **Very Low Drag**
- **Internally Adjustable Pitch**

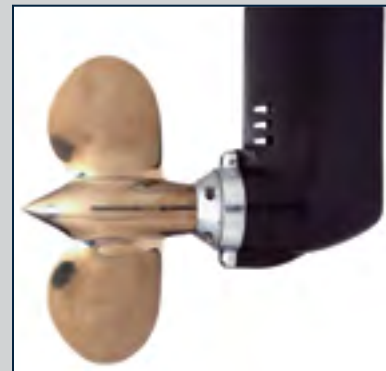

THREE & FOUR BLADE EASY

The Max-Prop Easy is a true step forward in Max-Prop design. The ease of installation and simple pitch adjustment make this model a great choice for a wide range of boats. The three blade design provides smooth and efficient power.

The Easy ships fully assembled, making installation similar to a fixed propeller, basically slide it onto the shaft, nut it in place and the propeller is ready to go.

As with all Max-Prop's the Easy pitch is adjustable. With the Easy pitch is adjustable in 2 degree increments, providing the ability to fine tune the loading of the engine. Moreover, pitch adjustment can be done in the water as the propeller does not need to be disassembled to change the pitch.



Features

- **Efficient Power**
- **Outstanding Reverse**
- **Smooth Operation**
- **Very Low Drag**
- **Very Easy Installation**
- **Adjustable Pitch**



FOUR BLADE V.P. FAST

The Max-Prop Fast is a leap forward from the VP 3 Blade Max-Prop design. The ease of installation and simple pitch adjustment make this model a great choice for a wide range of boats. The four blade design provides smooth and efficient power. It also offers better punch when powering into heavy wind and seas.

The VP Fast ships fully assembled, making installation similar to a fixed propeller, basically slide it onto the shaft, nut it in place and the propeller is ready to go.

As with all Max-Prop's the Fast pitch is adjustable. With the Fast pitch is adjustable in 1 degree increments, providing the ability to fine tune the loading of the engine. Pitch adjustment can be done in the water as it does not require any special tools or any disassembly to change the pitch.

This propeller is perfect for a moderate to heavy displacement cruising vessel, which can benefit from the extra power of the four blade design.



Features

- **Efficient Power**
- **Outstanding Reverse**
- **Smooth Operation**
- **Very Low Drag**
- **Very Easy Installation**
- **Externally adjustable Pitch**

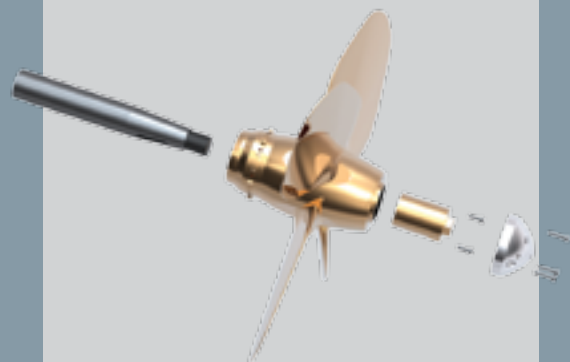
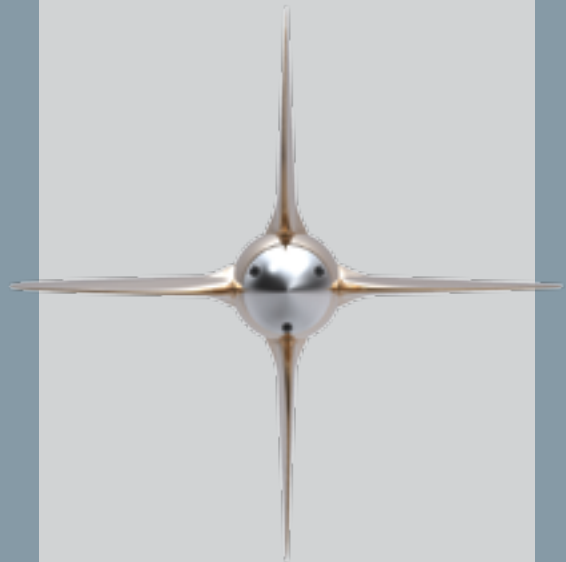

FIVE BLADE WHISPER

The Max-Prop Whisper uses five blades to provide ultra-quiet operation and impressive thrust. The resulting improved powering performance is especially noticeable when powering against heavy wind and seas. The five blade design also provides for a substantial noise and vibration reduction in all conditions.

The Whisper is based on the “Easy” design, so it ships fully assembled, making installation and pitch changes simple and fast. The pitch is adjustable 2 degree increments, providing the ability to fine tune the loading of the engine. Moreover, pitch adjustment can be done in the water as the propeller does not need to be disassembled to change the pitch.

The Whisper is designed for large vessels with heavy displacement. Which can benefit from the extra thrust and quiet performance of a five blade propeller

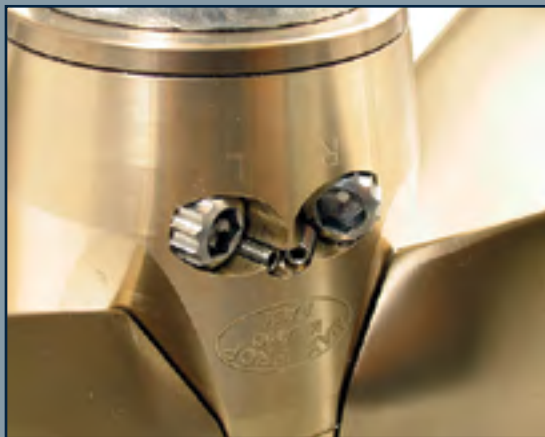

Features

- **Efficient Power**
- **Outstanding Reverse**
- **Ultra Smooth Operation**
- **Low Drag**
- **Easy Installation**
- **Adjustable Pitch**



Propeller Recommendation Sheet:

Name _____ Phone _____
 Street Address _____
 City _____ State _____ Zip _____ Fax _____
 Country _____ Email Address _____

Vessel Information:

Boat Manufacturer _____ Model _____
 Weight / Displ _____ Length Overall _____ Waterline Length _____
 Beam _____ Draft _____ Designed Hull Speed _____
 Fin Keel _____ Full Keel _____ Multihull _____
 *Engine Manufacturer _____ *Model Number _____
 *Rated Horsepower _____ *Max Rated RPM's _____ *Transmission Reduction Ratio _____
 Existing Propeller Diameter and Pitch _____ Two or Three Blade _____
 *Shaft Diameter _____ (All items with a *MUST be filled out to spec a propeller)

Shaft Taper Dimensions

If the vessel is not a U.S., Canadian, or European production boat it may be necessary to provide the taper dimensions listed below.

A = Shaft Diameter = _____
 F = Taper Length = _____
 L = Taper Small End = _____
 K = Keyway Width = _____
 H = Thread Diameter and Pitch = _____

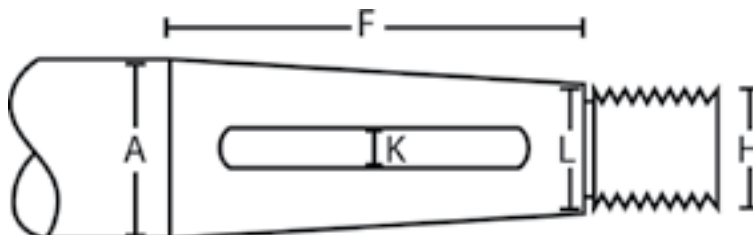

Aperture Dimensions

Due to the extended length of the Max-Prop, it may be necessary to provide the aperture dimensions listed below to ensure that the propeller will fit the boat.

I = _____ M = _____
 J = _____ N = _____
 K = _____ O = _____ L = _____

